

-NOTE-  
HOUSE WILL BE BUILT  
ACCORDING TO THIS PLAN.

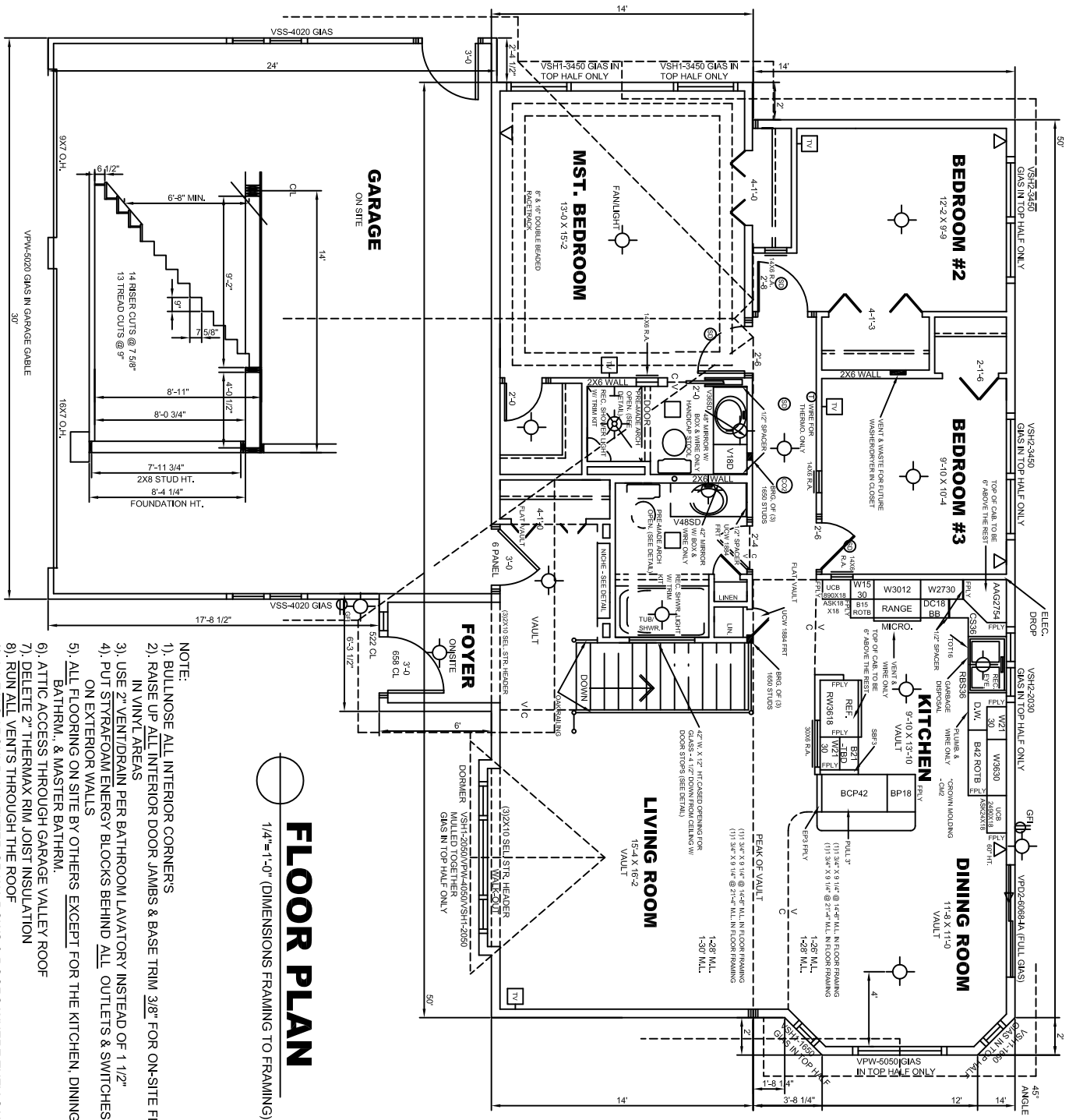

**FLOOR PLAN**  
1/4"=1'-0" (DIMENSIONS FRAMING TO FRAMING)

- NOTE:
- 1) BULLNOSE ALL INTERIOR CORNERS
  - 2) RAISE UP ALL INTERIOR DOOR JAMBS & BASE TRIM 3/8" FOR ON-SITE FLOORING EXCEPT IN VINYL AREAS
  - 3) USE 2" VENT/DRAIN PER BATHROOM LAVATORY INSTEAD OF 1 1/2"
  - 4) PUT STYRAFOAM ENERGY BLOCKS BEHIND ALL OUTLETS & SWITCHES LOCATED ON EXTERIOR WALLS
  - 5) ALL FLOORING ON SITE BY OTHERS EXCEPT FOR THE KITCHEN, DINING ROOM, MAIN BATHRM., & MASTER BATHRM.
  - 6) ATTIC ACCESS THROUGH GARAGE VALLEY ROOF
  - 7) DELETE 2" THERMAX RIM JOIST INSULATION
  - 8) RUN ALL VENTS THROUGH THE ROOF
  - 9) LINEALS AROUND ALL EXTERIOR WINDOWS & DOORS WHERE THEY CAN FIT

WINDOW SCHEDULE	WINDO. SCHEDULE
VPS-5050 GAS IN TOP HALF ONLY	6'-0" X 6'-7" 1/2"
VPS-2030 GAS IN TOP HALF ONLY	1'-2" 1/4" X 5'-1"
VPS-2030 GAS IN TOP HALF ONLY	3'-5" 1/4" X 5'-1"
VPS-2030 GAS IN TOP HALF ONLY	4'-1" 1/4" X 3'-1"
VPS-2030 GAS IN TOP HALF ONLY	6'-9" 1/4" X 5'-1"
VPS-2030 GAS IN TOP HALF ONLY	8'-1" 1/4" X 5'-1"
VPS-2030 GAS IN TOP HALF ONLY	WULLED TOGETHER
VPS-5050 GAS IN TOP HALF ONLY	5'-1" 1/4" X 5'-1"

GARAGE WINDOWS SHIPPED LOOSE

(2)VSS-4020 R.O. 4'-1" 1/4" X 2'-1" (GAS)  
(1)VPS-5050 R.O. 3'-1" 1/4" X 2'-1" (GAS)

EVERGREEN PROPERTIES HOMEOWNER SPECULATION

PROJECT TITLE: EVERGREEN PROPERTIES HOMEOWNER SPECULATION

PROJECT NO: W17548

DATE: 5-02-07

DYNAMIC HOMES LLC  
525 ROOSEVELT  
MINNEAPOLIS, MN 55402

DATE: 5-02-07

CHECKED BY: [ ]

DATE: [ ]

SHEET [ ] OF [ ]